

# Integra® Padgett®

Dermatomes

Limit uncertainty with  
quality and power from  
the brand you trust



INTEGRA®  
LIMIT UNCERTAINTY

## Electric Slimline Dermatome Models S and S6

The Integra® Padgett® Electric Slimline Dermatome Models S and S6 are intended for use in plastic surgery and/or burn treatment for the removal of skin grafts with varying depths.

Slim handpiece design



Model S6 features a 6 inch (15 cm) head

## Electric Slimline Dermatome Models S and S6

### Quality

- Padgett's tradition of offering high quality instrumentation
- Reliable and consistent, Integra® Padgett® blades
- Pin position guide provided to ensure dermatome is within specifications prior to use

### Control

- On/Off thumb-switch conveniently located on the top of the handpiece
- Adjustable depth gauge allows for grafts of varying thicknesses (0.05 to 0.76mm)

### Convenience

- Validated for steam (gravity and pre-vacuum), ethylene oxide, and STERRAD® sterilization
- Detachable, lightweight handpiece cable
- Model S6 can take 2, 3, 4, 5, 6 inch (5, 8, 10, 13, 15 cm) wide grafts
- 1 inch width clip available separately for both models

### Power

- Powerful 48-volt motor
- Power supply adapts to U.S. and International voltages

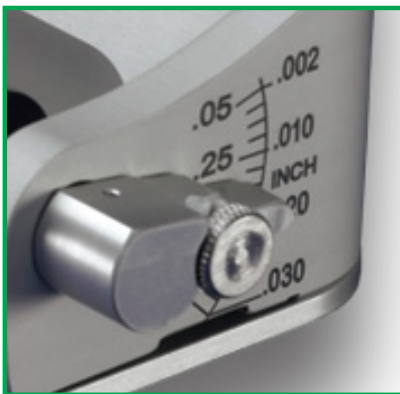

Graduation from 0.002 to 0.030 inch (0.05 to 0.76 mm)

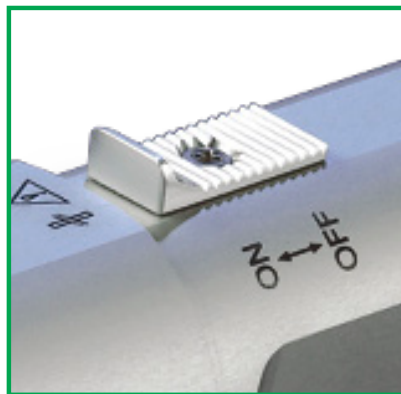

On/Off thumb-switch



Connection colors for ease of use

## Electric Slimline Dermatome Model S



### Electric Slimline Dermatome Model S

Key	Reference	Description
1	3539700	Slimline Dermatome Model S Complete Kit, Universal Power Supply, 110-230 Volts
<b>Complete Kit Includes:</b>		
2	DP0009	Model S Handpiece
3	DP0007	Power Supply
4	353971513	Handpiece Cable, 13' (3.96 m)
5	3539620	Power Supply Wall Cord, 120V (U.S., Canada & parts of Mexico)
6	35392662	Width Clip, 2" (5.08 cm)
7	35392663	Width Clip, 3" (7.62 cm)
8	35392664	Width Clip, 4" (10.16 cm)
9	35392660	Guard Plate
10	3539257	Dermatome Screwdriver
11	3539702	Dermatome Wrench
12	3539259	Pin Position Guide
	3539240	Carrying Case, Plastic (not shown)
	0032637	In-Service Video (not shown)

### Blades

Reference	Description
3539252	Sterile, Single Use, Box of 10

### Accessories and Components

Reference	Description
353971525	Handpiece Cable, 25' (7.62 m)
35392661	Width Clip, 1" (2.52 cm)
3539701	Dermatome Hex Nut (1 each)
3539256	Width Clip Screw (set of 2)
3539235	Power Supply Wall Cord, Continental Europe
3539236	Power Supply Wall Cord, British Style (UK, Hong Kong)
3539237	Power Supply Wall Cord, Italy

# Electric Slimline Dermatome Model S6

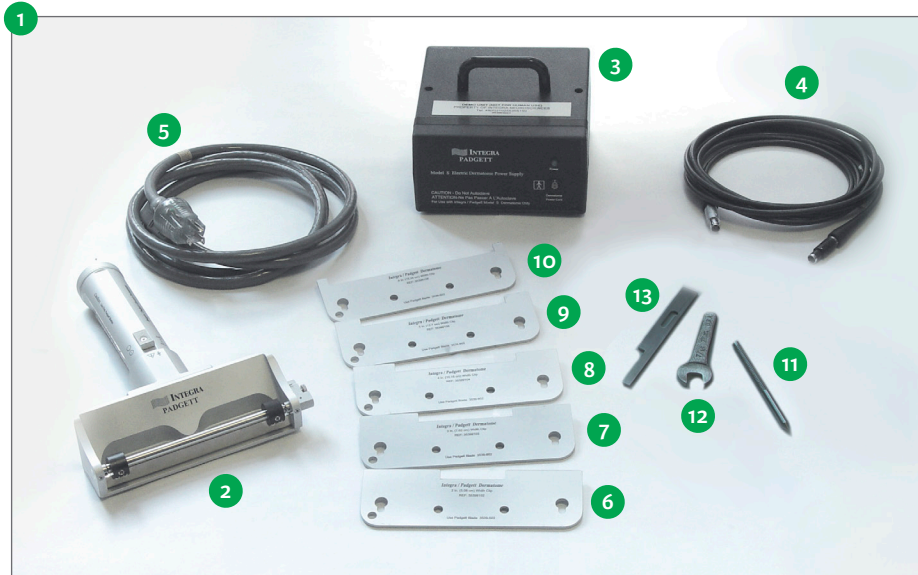

## Electric Slimline Dermatome Model S6

Key	Reference	Description
1	3539900	Slimline Dermatome Model S6 Complete Kit, Universal Power Supply, 110-230 Volts

### Complete Kit Includes:

2	DP0900	Model S6 Handpiece
3	DP0007	Power Supply
4	353971513	Handpiece Cable, 13' (3.96 m)
5	3539620	Power Supply Wall Cord, 120V (U.S., Canada & parts of Mexico)
6	35399102	Width Clip, 2" (5.08 cm)
7	35399103	Width Clip, 3" (7.62 cm)
8	35399104	Width Clip, 4" (10.16 cm)
9	35399105	Width Clip, 5" (12.7 cm)
10	35399106	Width Clip, 6" (15.2 cm)
	35399100	Guard Plate (not shown)
11	3539257	Dermatome Screwdriver
12	3539702	Dermatome Wrench
13	3539259	Pin Position Guide
	3539240	Carrying Case, Plastic (not shown)
	0032637	In-Service Video (not shown)

### Blades

Reference	Description
3539602	Sterile, Single Use, Box of 10

### Accessories and Components

Reference	Description
353971525	Handpiece Cable, 25' (7.62 m)
35399101	Width Clip, 1" (2.54 cm)
3539701	Dermatome Hex Nut (1 each)
3539256	Width Clip Screw (set of 2)
3539235	Power Supply Wall Cord, Continental Europe
3539236	Power Supply Wall Cord, British Style (UK, Hong Kong)
3539237	Power Supply Wall Cord, Italy

### Electric Dermatome Model B

The Integra® Padgett® Dermatome Model B is indicated for the removal of skin grafts with varying depths (between 0.13mm and 0.76mm).

#### Specifications

- Operates on either 120 VAC or 230 VAC (specify when ordering)
- The switch button for starting and stopping the motor is located directly under the index finger of the surgeon, and may be positioned on the opposite side for left-handed surgeons (specify)
- Model B can take standard 1, 2, 3, or 4 inch (2.54, 5.08, 7.62 and 10.16 cm) wide grafts
- Handpiece completely sterilizable (excludes the power pack)
- The instrument requires no lubrication by the surgeon
- The dermatome complete kit is provided in a plastic carrying case with the dermatome handpiece with cord, power supply, width clips, guard plate, dermatome screwdriver, and pin position guide



**Model B Handpiece  
with Cord**

# Electric Dermatome Model B

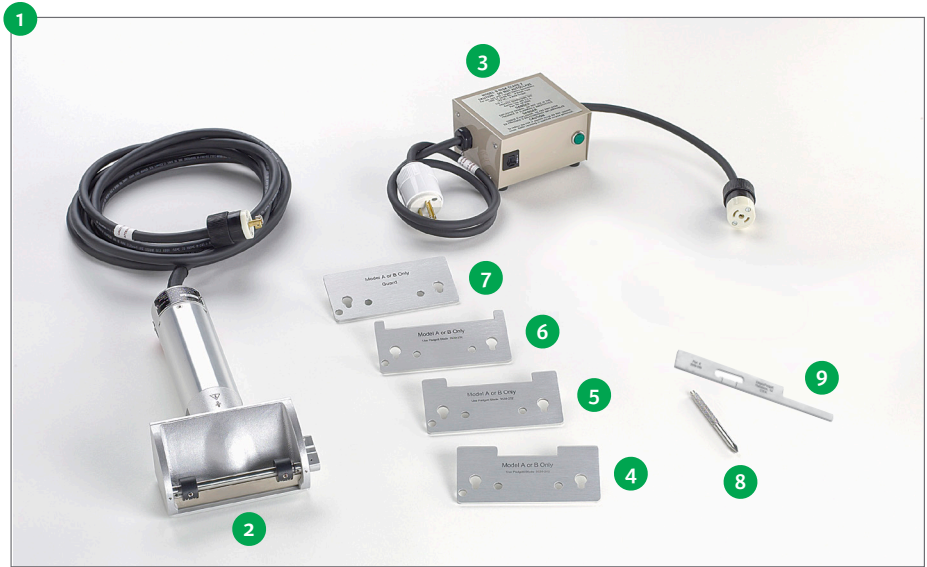

## Electric Dermatome Model B

Key	Reference	Description
1	3539250	Dermatome Model B Complete Kit, 120 Volts
	3539250230	Dermatome Model B Complete Kit, 230 Volts (not shown)
<b>Complete Kit Includes:</b>		
2	DP0001	Model B Handpiece with Cord
3	DP0002*	Power Supply, 120 Volts
	DP0004	Power Supply, 230 Volts (not shown)
4	35392552	Width Clip, 2" (5.08 cm)
5	35392553	Width Clip, 3" (7.62 cm)
6	35392554	Width Clip, 4" (10.16 cm)
7	35392550	Guard Plate
8	3539257	Dermatome Screwdriver
9	3539259	Pin Position Guide
	3539240	Carrying Case, Plastic (not shown)

## Blades

Reference	Description
3539252	Sterile, Single Use, Box of 10

## Accessories and Components

Reference	Description
3539251	Width Clip, 1" (2.54 cm)
3539256	Width Clip Screw (set of 2)

### Air Powered Dermatome Model C

The Air Dermatome Model C combines the quality of our Models S and S6 with the convenience of air driven power.

#### Specifications

- The on/off switch is thumb operated. Simply push it forward to operate in the pulse mode, or to the rear for continuous mode
- Flexible air hose
- Entire instrument and hose assembly is sterilizable (ethylene oxide sterilization recommended)
- Can take standard grafts 2, 3 or 4 inches wide (5.08, 7.62 or 10.16 cm)
- 1 inch width clip available separately
- Lightweight: 2 pounds (.91 kg)
- Improved handle design
- Supplied complete with carrying case

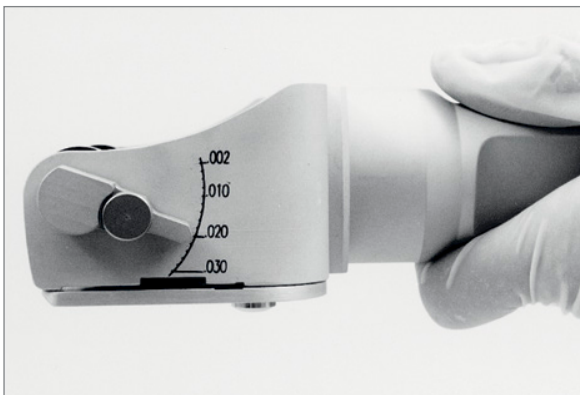

Depth Gauge



Air Hose



## Air Powered Dermatome Model C



### Air Dermatome Model C

Key	Reference	Description
1	3539500	Air Dermatome Model C Complete Kit
<b>Complete Kit Includes::</b>		
2	APO001	Air Dermatome Model C Handpiece
3	3539401	Air Hose, 12' (3.66 m)
4	35392662	Width Clip, 2" (5.08 cm)
5	35392663	Width Clip, 3" (7.62 cm)
6	35392664	Width Clip, 4" (10.16 cm)
7	35392660	Guard Plate
8	3539257	Dermatome Screwdriver
9	3539259	Pin Position Guide
	3539240	Carrying Case, Plastic (not shown)

### Caution

The Air Dermatome Model C is only compatible with a standard air Shradler connection.

### Blades

Reference	Description
3539252	Sterile, Single Use, Box of 10

### Accessories and Components

Reference	Description
35392661	Width Clip, 1" (2.54 cm)
APO355	Air Gasket, Green (not shown)

### How to Use Integra Padgett Dermatomes



Warning: Read the User's Guide thoroughly before using Integra Padgett Dermatomes.

#### Switch on Models S and S6:

- The on/off switch is on top of the hand piece and is operated with the thumb.

#### Switch on Model B:

- The switch is operated with the index finger.

#### Switch on Model C:

- As it is shown in this view, an ON/OFF switch is operated with the thumb. Push the switch forward for pulse mode or to the rear for continuous mode.

Model C

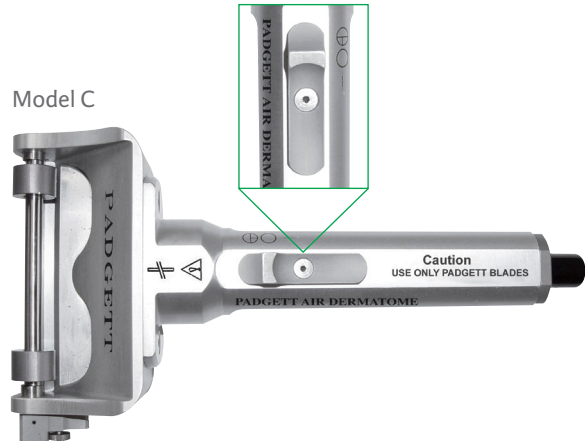

- The blade should be given a very thin coat of sterile mineral oil on both sides before insertion. Hold the dermatome in both hands as shown in the picture. Place the blade such that the "This Side Up" marker is facing the operator. The blade grommet hole is to be placed over the dermatome's oscillating pin. Refer to the illustration. Place both thumbs over the eccentric screws and push the blade down and forward. The blade will easily fall into place. The blade and dermatome blade bed should be free from particulate or other foreign objects which may hinder free movement of the blade. The blade is removed by lifting up with both index finders using the slots at each end of the blade.

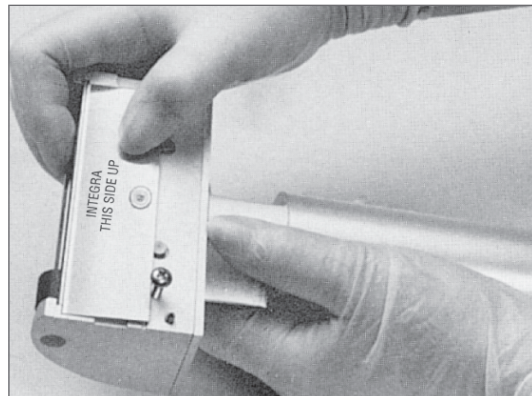

#### Caution

Integra Padgett dermatomes are only compatible with Integra Padgett blades

- Select the desired width clip. A one inch (2.54 cm) is available by special order. Fasten in place with the Integra Padgett supplied screwdriver as shown. Be sure there is no lint or other foreign object on the width clip that could restrict free movement of the blade. The screws should be sufficiently tightened to prevent screw loosening during dermatome operation. Excessively tightened screws may cause dermatome performance issues or permanent device damage. Only use the Integra Padgett supplied screwdriver to tighten the screws.

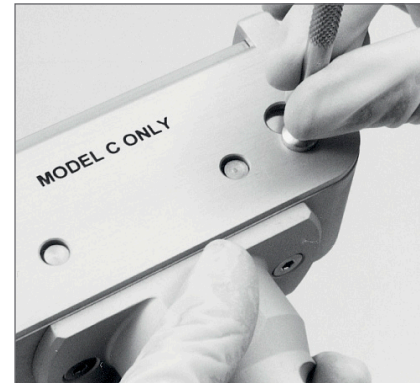

- The desired thickness of the graft is predetermined by the operator and set by using the pointer on the thickness guide scale. The actual thickness of the harvested tissue is highly dependent upon the operator technique and the condition of the tissue being harvested. The thickness guide scale provides both inch and millimeter values.

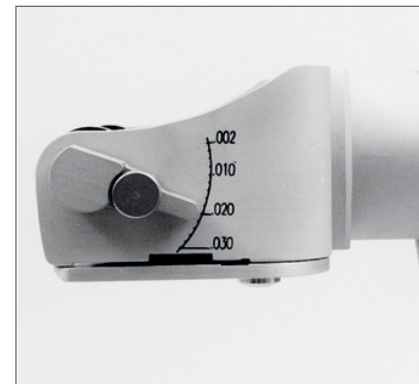

- Much of the weight of the motor should be carried by the hand that holds the dermatome to maintain a reasonably light pressure between the cutting edge and the patient's body. The instrument should be held at a 25° - 45° angle. The cut graft automatically folds itself into the "pocket" of the dermatome head. To sever the graft, simply lift the dermatome up and away from the donor site.



## United States, Canada, Asia, Pacific, Latin America

USA 877-468-5572 ▪ 800-275-7192 fax  
Outside USA 914-789-7094 ▪ 609-750-4218 fax  
[integralife.com](http://integralife.com)

## Europe, Middle-East, Africa

International: +33 (0)4 37 47 59 50 ▪ +33 (0)4 37 47 59 25 fax  
Benelux: +32 (0)2 257 4130 ▪ +32 (0)2 253 2466 fax  
France: +33 (0)4 37 47 59 10 ▪ +33 (0)4 37 47 59 29 fax  
Switzerland: +41 (0)22 721 23 00 ▪ +41 (0)22 721 23 99 fax  
United Kingdom: +44 (0)1 264 345 781 ▪ +44 (0)1 264 363 782 fax  
[integralife.eu](http://integralife.eu)



Integra LifeSciences Services France  
Immeuble Séquoia 2  
97 allée Alexandre Borodine  
Parc Technologique de la Porte des Alpes  
69800 Saint Priest – France

## Manufacturer:



Integra LifeSciences Corporation  
4900 Charlemar Drive, Building A  
Cincinnati, OH 45227 ▪ USA

Availability of these products might vary from a given country or region to another, as a result of specific local regulatory approval or clearance requirements for sale in such country or region.

- Always refer to the appropriate instructions for use for complete clinical instructions.
- Non contractual document. The manufacturer reserves the right, without prior notice, to modify the products in order to improve their quality.
- Warning: Applicable laws restrict these products to sale by or on the order of a physician.

## Additional information for EMEA Customers only:

Products mentioned in this document are CE class I, IIa, IIb or III devices. Contact Integra should you need any additional information on devices classification. All the medical devices mentioned on this document are CE marked according to European council directive 93/42/EEC on medical devices and its relatives, unless specifically identified as "NOT CE MARKED".

Integra, the Integra logo and Padgett are registered trademarks of Integra LifeSciences Corporation or its subsidiaries in the United States and/or other countries. STERRAD is a registered trademark of Advanced Sterilization Products. ©2013 Integra LifeSciences Corporation. All rights reserved. Printed in USA. ?M 0224825-1-ENG